

Cabinetry *Direct*

CABINET SPEC'S

PRODUCT	SPECIFICATION
① Face Frames	3/4" x 1 1/2" (Dover, Essex, Branford, Trenton, Kingston, Norwich, Yarmouth) 3/4" x 1 9/16" Mortise & Tenon Construction (Georgetown, Wheaton)
② End Panel	1/2"-thick Plywood
③ Top and Bottom (Walls)	1/2"-thick Plywood
④ Bottom (Bases)	3/8"-thick Plywood
⑤ Shelves	Adjustable 3/4"-thick Plywood, Edgebanded on front
⑥ Back	1/2"-thick Solid Plywood (Georgetown and Wheaton have 1/8"-thick Plywood framed to 1/2")
⑦ Hang Rails (Walls)	5/8"-thick Solid Wood
⑧ Toe Kick	1/2"-thick Plywood, Unfinished, Recessed (Georgetown and Wheaton have matching toe kick)
⑨ Drawer Box	Unassembled, Dovetail with 3/4"-thick Solid Wood sides and 3/8"-thick bottom
⑩ Glides	Full-extension, soft close, undermount drawer glides
⑪ Hinges	6-way-Adjustable, Concealed, with Soft Close Integrated Hinge
Interiors	Finished in Natural Maple (Georgetown and Kingston have finish matching the doors)
Soft Close Doors	All Designer line kitchen cabinets come standard with soft close doors

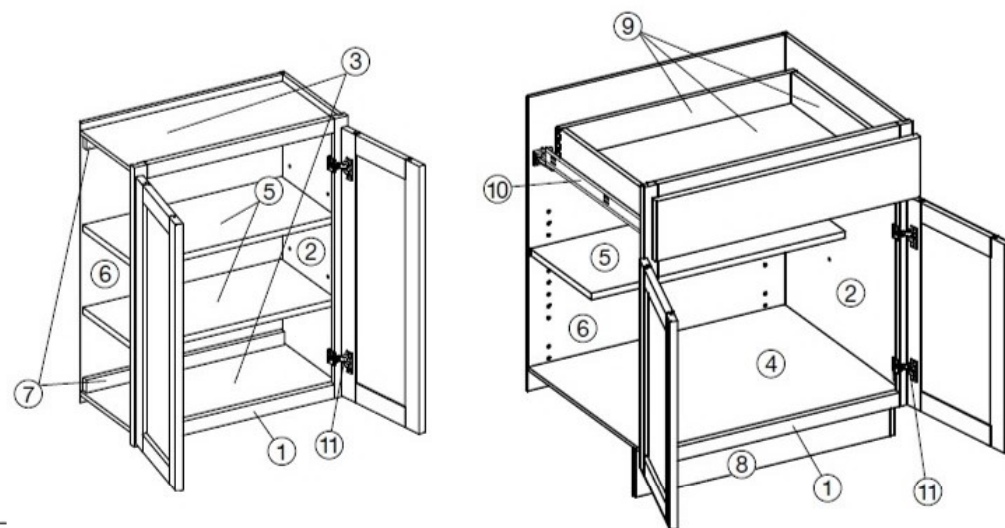



Cabinetry *Direct*

WALL CABINET SPEC'S

DESIGN AND MATERIALS

The box construction of all wall cabinets will be the same.

- 1-1/2" solid wood face frame with a unique semi dovetail joinery that locks the side panel with the face frame. All other joinery is via dadoes which interlock the components. All assembly is by pin and glue.
- 1/2" furniture grade plywood with select birch wood veneer on both the interior and exterior, which is used for the top, bottom, and sides.
- Interiors are natural Birch veneers UV clear coated with exterior sides finished to match finish color of doors with called out skin.
- 1/2" framed panel with a 1/4" panel which dadoes into the side panel with 1/2" inset from the back.
- 3/4" adjustable engineered wood shelf, finished with Birch wood veneer top and bottom edge banded on the front leading edge.
- All hinges are 6-way adjustable and have an internal soft close mechanism on each hinge.

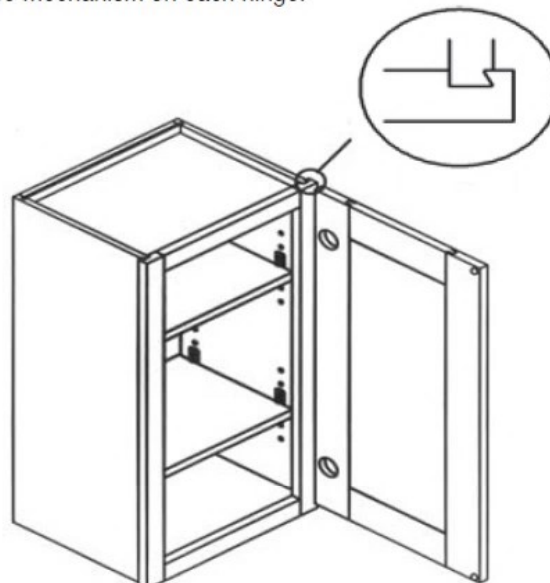

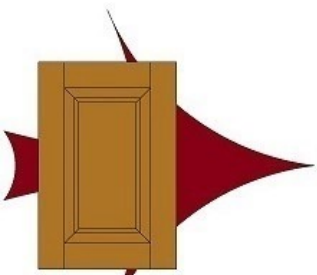

Cabinetry *Direct*

BASE CABINET SPEC'S

DESIGN AND MATERIALS

The box construction of all base cabinets will be the same.

- 5/8" solid wood dove tail construction on all sides of drawer box with UV clear coat on all exposed surfaces. Drawer glides are all steel constructed soft close mechanism.
- 1-1/2" solid wood face frame with a unique semi dovetail joinery that locks the side panel with the face frame. All other joinery is via dadoes which interlock the components. All assembly is by pin and glue.
- 1/2" furniture grade plywood with select birch wood veneer on both the interior and exterior, which is used for the bottom and sides.
- 1/2" furniture grade plywood with select birch wood veneer on both the interior and exterior, which is used for the bottom and sides.
- Interiors are natural Birch veneers UV clear coated with exterior sides finished to match finish color of doors with called out skins.
- 4 1/2" toe kick height by

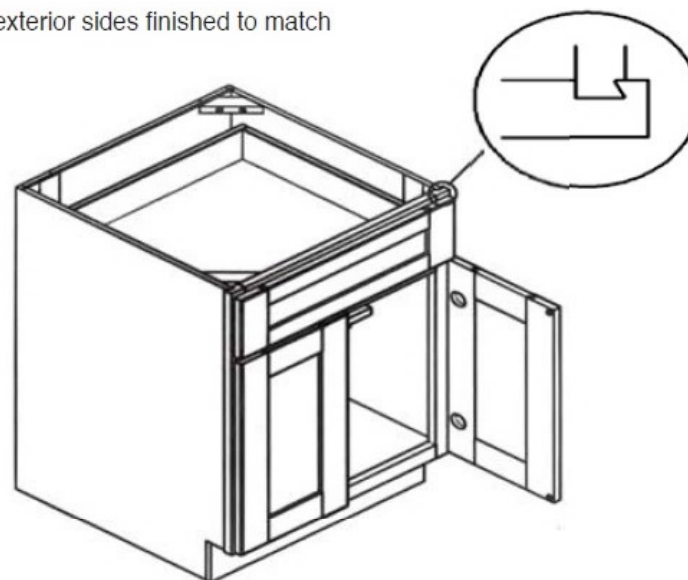

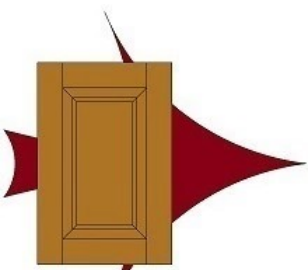

Cabinetry *Direct*

TALL CABINET SPEC'S

DESIGN AND MATERIALS

The Box construction of all tall cabinets will be the same.

- 1-1/2" solid face frame with a unique semi dovetail joinery that locks the side panel with the face frame. All other joinery is via dados which interlock the components. All assembly is by pin and glue.
- 1/2" furniture grade plywood with select birch wood veneer on both the interior and exterior, which is used for the top, bottom and sides.
- Interiors are natural Birch veneers UV clear coated with exterior sides finished to match finish color of doors with called out skins.
- 1/2" framed panel with a 1/4" panel which dados into the side panel with 1/2" inset from the back.
- 3/4" adjustable engineered wood shelf, finished with Birch wood veneer top and bottom and wood edge banded on the front leading edge.
- All hinges are 6-way adjustable and have an internal soft close mechanism on each hinge.

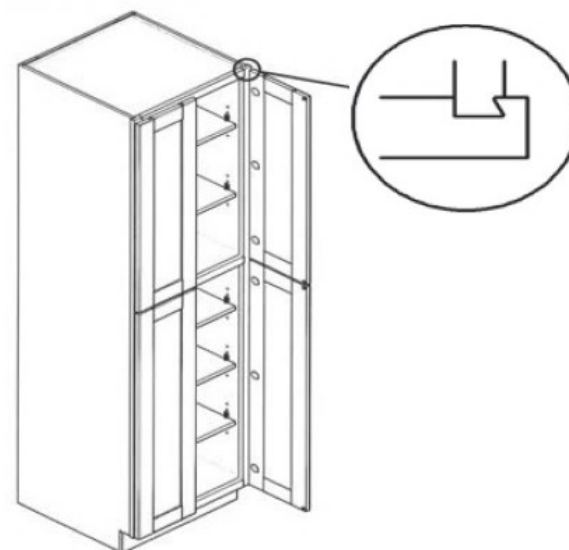

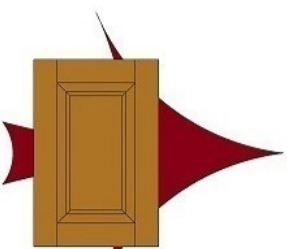

Cabinetry *Direct*



DOVER White



YARMOUTH Ivory



TRENTON Ivory



WHEATON Creme



LIBERTY White



LIBERTY Gray

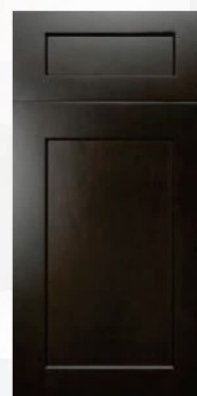

LIBERTY Espresso



BELMONT Gray

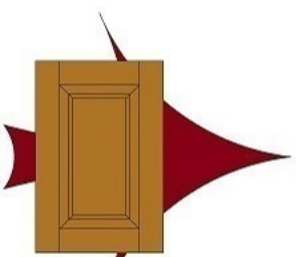

Cabinetry *Direct*



BELMONT Light
Gray



BRANFORD Espresso



GEORGETOWN
Cherry



SARATOGA
Cinnamon



KINGSTON Golden

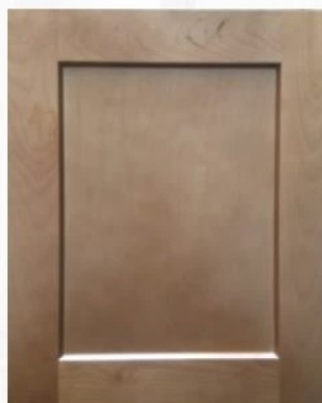

AMESBURY Golden

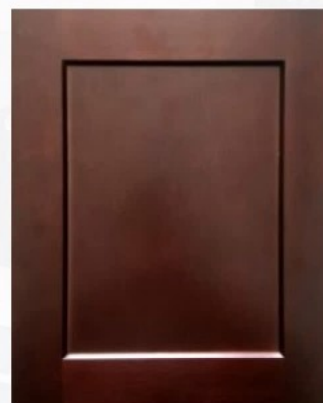

AMESBURY Cherry

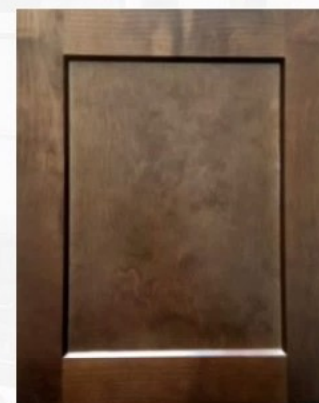

AMESBURY Brown

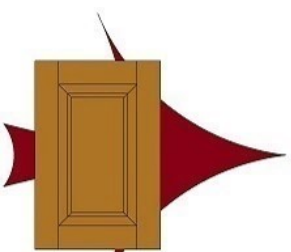

Cabinetry *Direct*



UPTON Brown

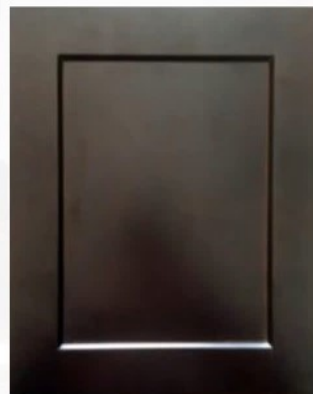

AMESBURY Espresso



QUINCY Golden



PORTLAND
Chestnut



Atlas Blanco



Atlas Stella



Essense Shaker
Cemento

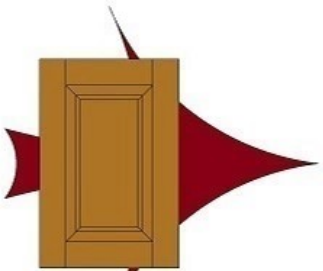

Cabinetry *Direct*

AMESBURY Shaker Door Brown Stained Finish on Maple



AMESBURY DOOR Brown

The Amesbury Door is a Brown stained finish on solid MAPLE Hardwood. This door is only available in this color, golden, espresso, & brown in our STOCK cabinetry. This is available in any wood species* & finishes in our CUSTOM cabinetry.



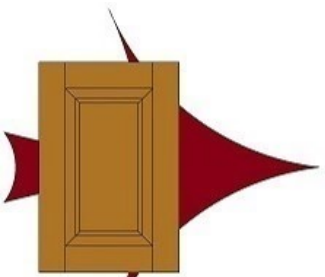

Cabinetry *Direct*

AMESBURY Shaker Door Cherry Stained Finish on Maple



AMESBURY DOOR
Cherry

The Amesbury Door is a Cherry stained finish on solid MAPLE Hardwood. This door is only available in this color, golden, espresso, & brown in our STOCK cabinetry. This is available in any wood species* & finishes in our CUSTOM cabinetry.



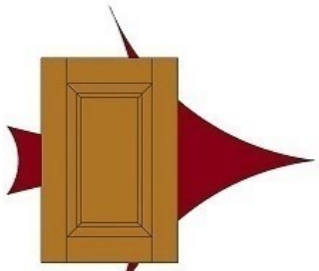

Cabinetry *Direct*

AMESBURY Shaker Door Espresso Stained Finish on Maple



AMESBURY DOOR
Espresso

The Amesbury Door is an Espresso stained finish on solid MAPLE Hardwood. This door is only available in this color, golden, cherry, & brown in our STOCK cabinetry. This is available in any wood species* & finishes in our CUSTOM cabinetry.



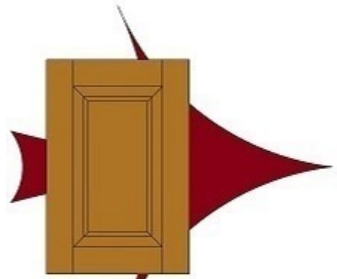

Cabinetry *Direct*

AMESBURY Shaker Door Golden Stained Finish on Maple

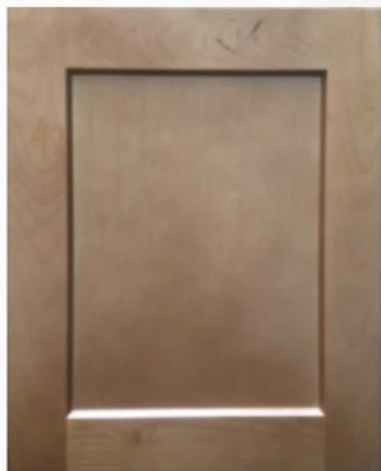

AMESBURY DOOR
Golden

The Amesbury Door is a Golden stained finish on solid MAPLE Hardwood. This door is only available in this color, cherry, espresso, & brown in our STOCK cabinetry. This is available in any wood species* & finishes in our CUSTOM cabinetry.





Cabinetry *Direct*

BELMONT Door Gray Painted Finish on Birch



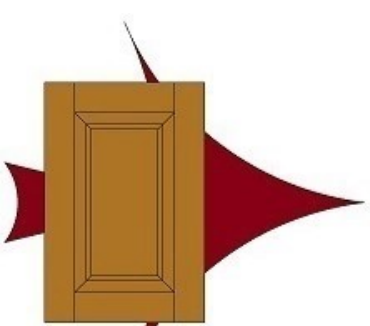

Cabinetry *Direct*

BELMONT Door Light Gray Painted Finish on Birch



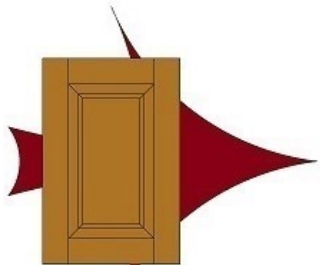

Cabinetry *Direct*

BRANFORD Door Espresso Stained Finish on Maple



BRANFORD DOOR

The Branford Door is the sister door to the TRENTON door. It is a solid maple hardwood door with an espresso stained finish. This door is only available in this color in STOCK. It is available in any wood species* & finishes in our CUSTOM cabinetry.

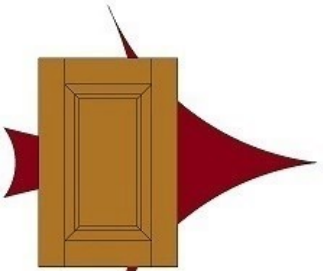

Cabinetry *Direct*

DOVER Shaker Door White Painted Finish on Maple



DOVER DOOR

The Dover Door is a solid maple hardwood door, with a 1/4" veneer / Maple Veneer -MDF center panel, with a white painted finish. This door is only available in this color in STOCK. It is available in any wood species* & finishes in our CUSTOM cabinetry.



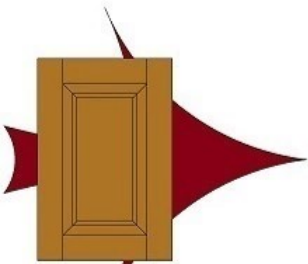

Cabinetry *Direct*

GEORGETOWN Door Cherry Stain with Black Glaze Finish on Maple



GEORGETOWN DOOR

The Georgetown Door is a solid maple hardwood door with a cherry stain & black glaze finish. This door is only available in this color in STOCK. It is available in any wood species* & finishes in our CUSTOM cabinetry.



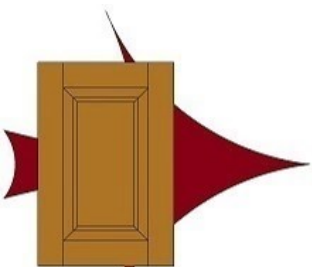

Cabinetry *Direct*

KINGSTON Door Medium Stain with Black Glaze Finish on Maple



KINGSTON DOOR

The Kingston Door is a solid maple hardwood door with a medium stain & black glaze finish. This door is only available in this color in STOCK. It is available in any wood species* & finishes in our CUSTOM cabinetry.



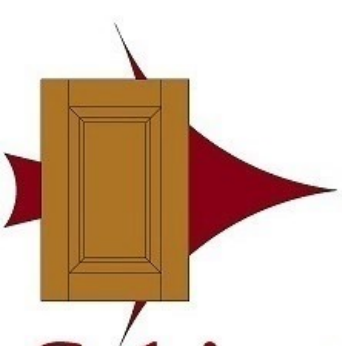

Cabinetry *Direct*

LIBERTY Shaker Door Espresso Stained Finish on Birch

\$3,284.88

CALL, EMAIL, or COME-IN for SALE PRICING Info

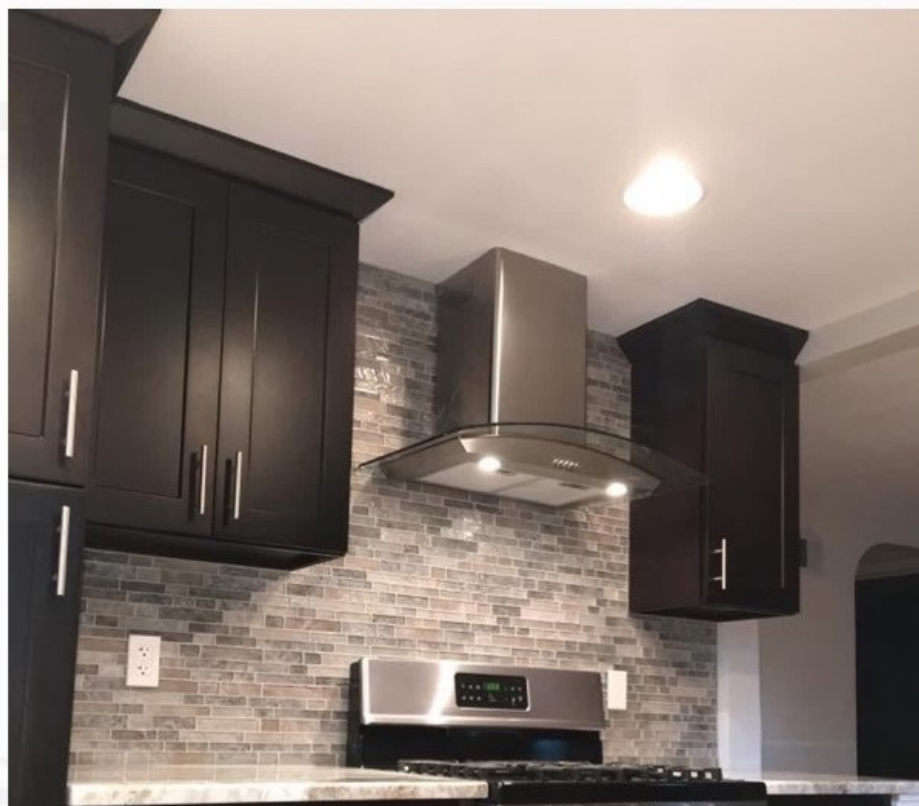

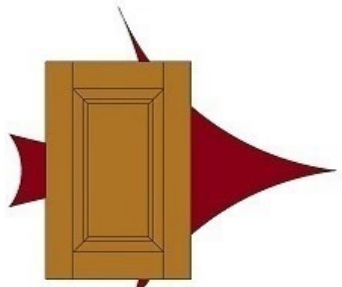

Cabinetry *Direct*

LIBERTY Shaker Door Gray Painted Finish on Birch



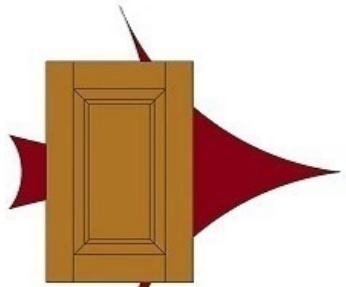

Cabinetry *Direct*

LIBERTY Shaker Door White Painted Finish on Birch

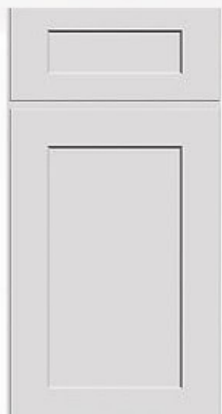

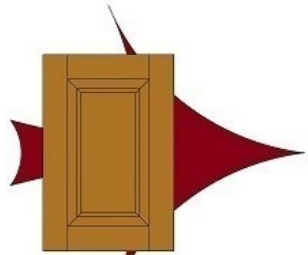

Cabinetry *Direct*

3 NEW STOCK DOORS



Atlas Blanco



Atlas Stella



Essense Shaker
Cemento

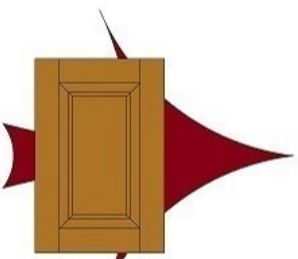

Cabinetry *Direct*

PORTLAND Door Chestnut Stained Finish on Birch



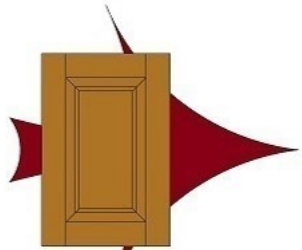

Cabinetry *Direct*

QUINCY Door Golden Stained Finish on Maple



QUINCY DOOR

The Quincy Door is a Golden stained finish on solid MAPLE hardwood. This door is available in this color, cherry, espresso, & brown in our STOCK cabinetry. (SEE AMESBURY DOOR SAMPLES TO VIEW COLORS) This is available in any wood species* & finishes in our CUSTOM cabinetry.



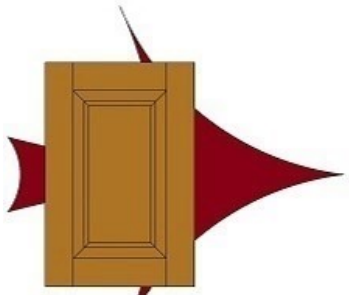

Cabinetry *Direct*

SARATOGA Door Cinnamon Stained Finish on Birch



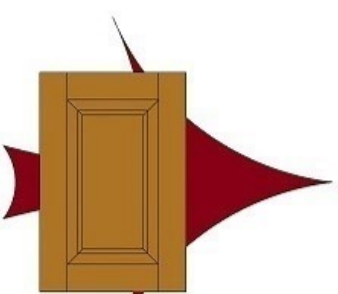

Cabinetry *Direct*

TRENTON Door Ivory Painted Finish on Maple



TRENTON DOOR

The Trenton Door is a solid maple hardwood door with an ivory painted finish. This door is only available in this color in STOCK. It is available in any wood species* & finishes in our CUSTOM cabinetry.



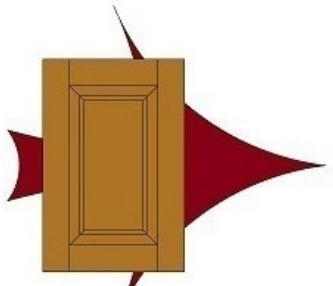

Cabinetry *Direct*

UPTON RUSTIC Shaker Door Brown Stained Finish on Rustic Maple



UPTON DOOR Brown

The Upton Door is a Brown stained finish on solid RUSTIC MAPLE Hardwood.

This door is only available in this color in our STOCK cabinetry. This is available in any wood species* & finishes in our CUSTOM cabinetry.



Phoenix Cabinetry
EXCLUSIVELY by Cabinetry *Direct*



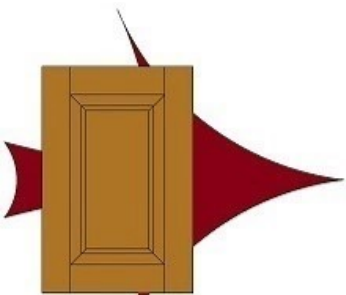

Cabinetry *Direct*

WHEATON Door Creme Painted finish with Finish on Maple



WHEATON DOOR

The Wheaton Door is a solid maple hardwood door with a creme paint & light glaze finish. This door is only available in this color in STOCK. It is available in any wood species* & finishes in our CUSTOM cabinetry.





Cabinetry *Direct*

YARMOUTH Door Ivory Painted Finish on Maple



YARMOUTH DOOR



The Yarmouth Door is a solid maple hardwood door with an ivory painted finish. This door is only available in this color in STOCK. It is available in any wood species* & finishes in our CUSTOM cabinetry.